

NewTeam Ltd.
Customer Service Dept.
Brunel Road
Earlstrees Industrial Estate
Corby
Northants
NN17 4JW

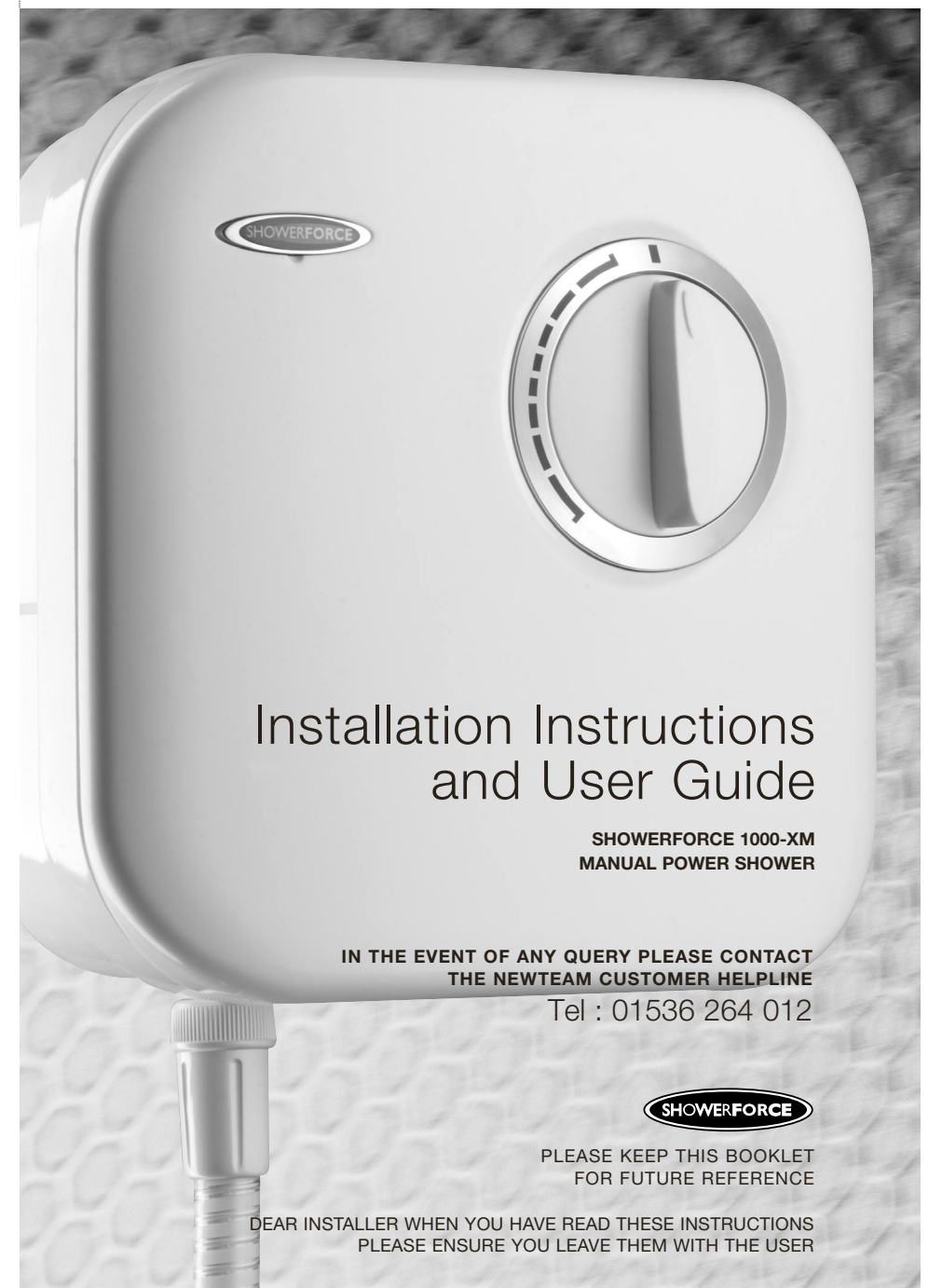

Installation Instructions and User Guide

**SHOWERFORCE 1000-XM
MANUAL POWER SHOWER**

**IN THE EVENT OF ANY QUERY PLEASE CONTACT
THE NEWTEAM CUSTOMER HELPLINE**

Tel : 01536 264 012



**PLEASE KEEP THIS BOOKLET
FOR FUTURE REFERENCE**

**DEAR INSTALLER WHEN YOU HAVE READ THESE INSTRUCTIONS
PLEASE ENSURE YOU LEAVE THEM WITH THE USER**

Product Features

ShowerForce 1000-XM

- Integral pump
- Push-fit fittings
- 3 spray massage handset
- Manual control
- BEAB approval of safety

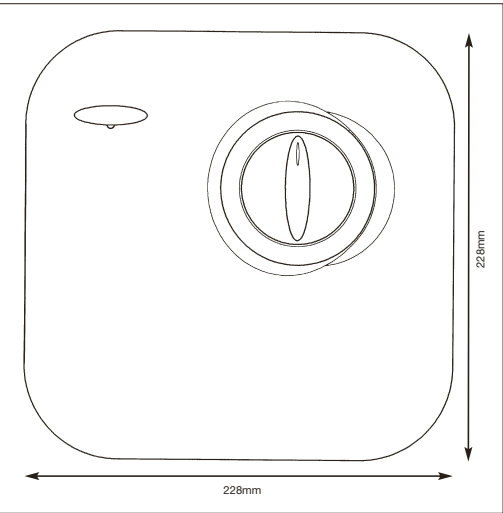

Guarantee/Service Policy

Guarantee

Thank you for purchasing a ShowerForce product, which has been designed, manufactured and tested, in the U.K., to the highest standards, by NewTeam Ltd.

Guarantee. 2 Years, 1 Year - Parts and Labour Second Year- Parts Only

This is provided that:

1. The guarantee registration card is completed and returned within ten days complete with a copy of proof of purchase.
2. The product is installed and operated in accordance with our instructions and has not been misused or damaged.

This in no way affects your statutory rights as a consumer.

The information on the Guarantee card helps ShowerForce to process any claims and contact you about your product and its maintenance if required. The registration of your personal details is purely for Showerforce use, and the other information helps us to make products for the future.

ShowerForce Shower products are designed, manufactured and tested to the highest standards.

Should a complaint arise, products are guaranteed against faulty workmanship and materials for a period of 12 months from the date of purchase, when in domestic use (second year guarantee is parts only). For your guarantee to be valid, your shower pump must be installed by a competent person, in accordance with the instruction manual.

ShowerForce will repair or replace (at our option), free of charge, any faulty components during the guarantee period, provided it has been maintained and operated in accordance with our instructions, and has not been misused or damaged.

Modification or repair of this product by person(s) not authorised by ShowerForce will invalidate this guarantee.

This guarantee applies to products purchased within the United Kingdom or Republic of Ireland, but does not apply to products used commercially.

This guarantee does not affect your statutory rights.

Service Policy - Replacement Parts Policy

IMPORTANT:

In the event of product or component malfunction, DO NOT tamper with or remove the product from site. Telephone ShowerForce Customer Service Department on 01536 264 012 and be prepared with the date of purchase, model number and a description of the complaint.

Our service staff are fully qualified to advise on correct installation procedures and will be able to diagnose whether the fault will require a replacement part or a visit from a ShowerForce engineer.

If required, a service call will be booked, and either yourself or an appointed representative (who should be a person of 18 years or over) must be present during the visit.

All site visits to product within the guarantee period will be carried out free of any parts or labour charges provided the conditions of the guarantee have been adhered to. (Second year guarantee is parts only)

All site visits to product out of guarantee will be subject to charges for parts and labour which is payable by you or your appointed representative at the time of the visit. Charges will also be levied on cancelled appointments, unless advised to ShowerForce at least 24 hours in advance of the agreed date and time.

We reserve the right not to undertake work where payment cannot be made to our engineer at the time of the visit.

ShowerForce hold stocks of components for all their range of products and these will be maintained for the duration of their life.

Should a product be discontinued, spare parts stocks will be maintained, but in the event of a part becoming unavailable ShowerForce reserve the right to supply a substitute of equal quality.

The following payment methods can be used to obtain spare parts:

By post, pre-payment of proforma invoice by cheque or postal order.

By telephone quoting credit card (Mastercard, Visa or Visa Delta) details.

REPLACEMENT PARTS:
Tel: 01536 409 222 • Fax: 01536 409 201 • E-Mail:spares@newteam.co.uk

CUSTOMER SERVICE HOTLINE:
Tel: 01536 264 012 • Fax: 01536 409 201 • E-Mail:service@newteam.co.uk

Part No. 404-0100 Issue 06/02

Guarantee



GUARANTEE CARD

Please post immediately enclosing a copy of proof of purchase



ShowerForce Power Shower 1000-XM

Proof of purchase enclosed
YES ☐ NO ☐

NAME: _____

ADDRESS: _____

POSTCODE: _____

DATE OF PURCHASE: _____

PRODUCT PURCHASED FROM: _____

TOWN: _____

FOR SHOWERFORCE USE
AFFIX PRODUCT LABEL HERE

This label identifies your product and provides all the information needed

ShowerForce/NewTeam's philosophy is to offer outstanding products with quality and integrity, please help us by taking the time to answer the following questions. Thank you.

MARKETING INFORMATION

1. Please state your profession: Plumber ☐ Builder ☐ Electrician ☐ Customer ☐ Other ☐ (please specify) _____

2. Please state the reason for purchasing a shower: New Build ☐ Replacement ☐ Renovation ☐ Other ☐ (please specify) _____

3. If the product is a replacement shower, please state the type and make of the shower it is replacing: _____

4. What influenced you to purchase the 1000-XM Power Shower? Advertisement ☐ Trade Press ☐ Recommendation from Stockist ☐ Recommendation from Installer ☐ Other ☐ (please specify) _____

5. Please state your main reason for purchasing the 1000-XM Power Shower: ShowerForce Product Knowledge ☐ Product Features ☐ Product Styling ☐ Price ☐ Other ☐ (please specify) _____

Please tick here if you do not require any further information or product updates from NewTeam ☐

POST BACK
FOLD AND TAPE AS INSTRUCTED OVERLEAF

Spare Parts Listing

ShowerForce 1000-XM

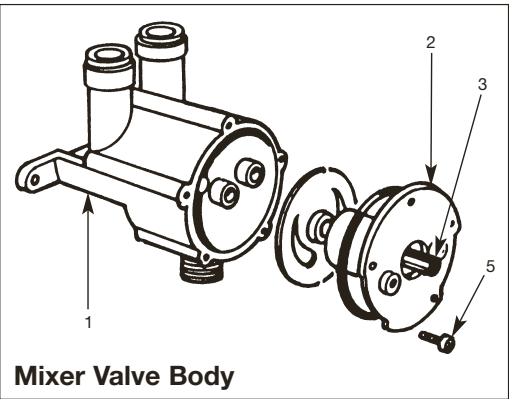
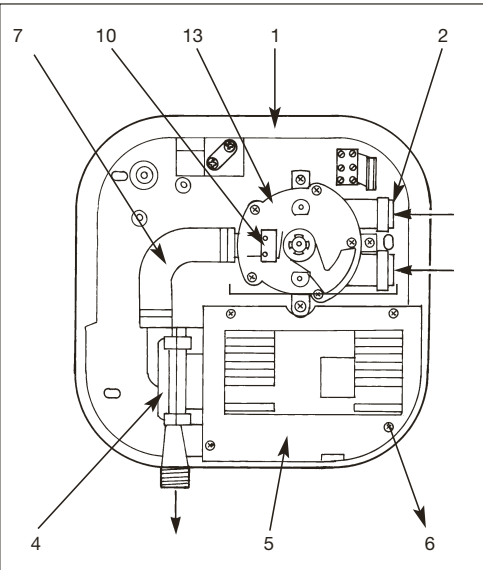
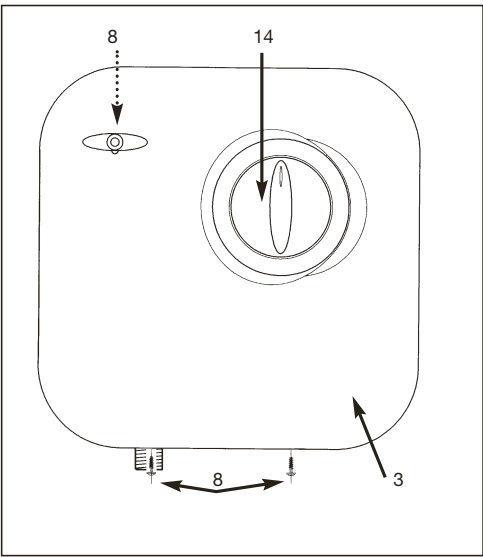

Mixer Valve Body

Item No.	Part No.	Description
1.	SP-087-0104	Wall Box Complete
2.	SP-086-0008	Pipe Grommet
3.	SP-087-0500	Front Cover & Graphic Ring
4.	SP-087-0109	Pump Unit
5.	SP-087-0035	Motor Cover
6.	SP-490-0017	Motor Cover Screws
7.	SP-087-0037	Rubber Elbow
8.	SP-490-0014	Front Cover Screws
9.	SP-087-0089	Temperature Limit Stop (Not Shown)
10.	SP-092-0150	Micro Switch
11.	SP-086-0061	Long Inlet Elbow x 2 (Not Shown)
12.	SP-087-0068	Pipe Cover (Not Shown)
13.	SP-087-0152	Mixer Valve complete (Manual)
14.	SP-087-0088	Control Knob
15.	SP-280-0500	Spirit Rail & Slider Assembly (Not Shown)
16.	SP-280-0032	Hose Retainer & Gel Hook (Not Shown)
17.	SP-280-0024	Rail Ends (Not Shown)
18.	SP-285-0018-WT	1.25m x 11mm Hose (Not Shown)
19.	SP-176-0004-WT	Handset (Not Shown)

Item No.	Part No.	Description
1.	SP-087-0101	Mixer Body
2.	SP-087-0002	Mixer Body Cover
3.	SP-085-0003	Mixer Control Spindle
4.	SP-320-0100	Mixer Seal Kit
5.	SP-490-0017	Mixer Body Screw
6.	SP-085-0031	Service Kit

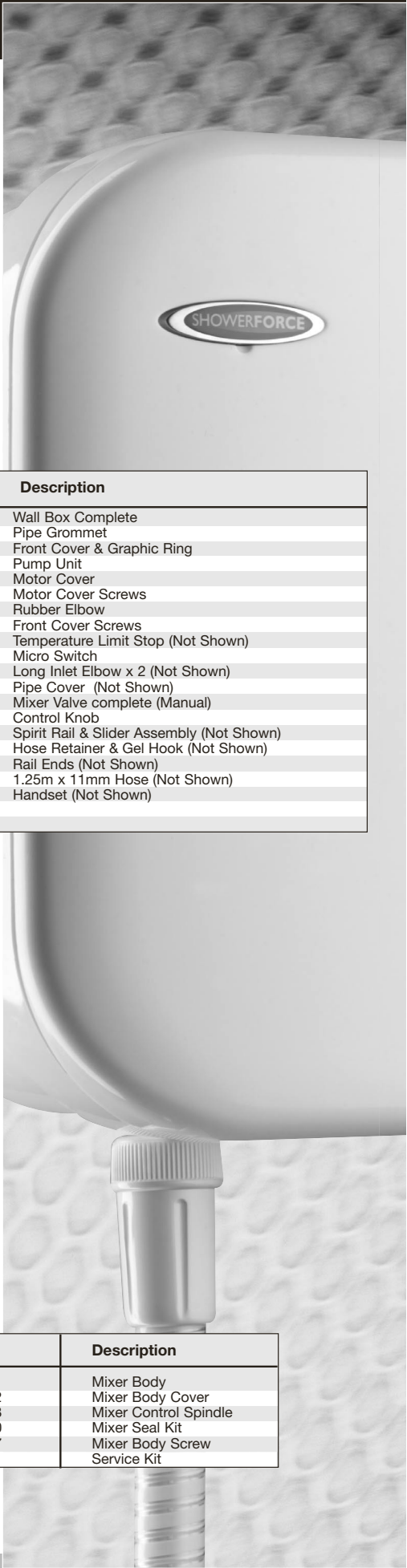

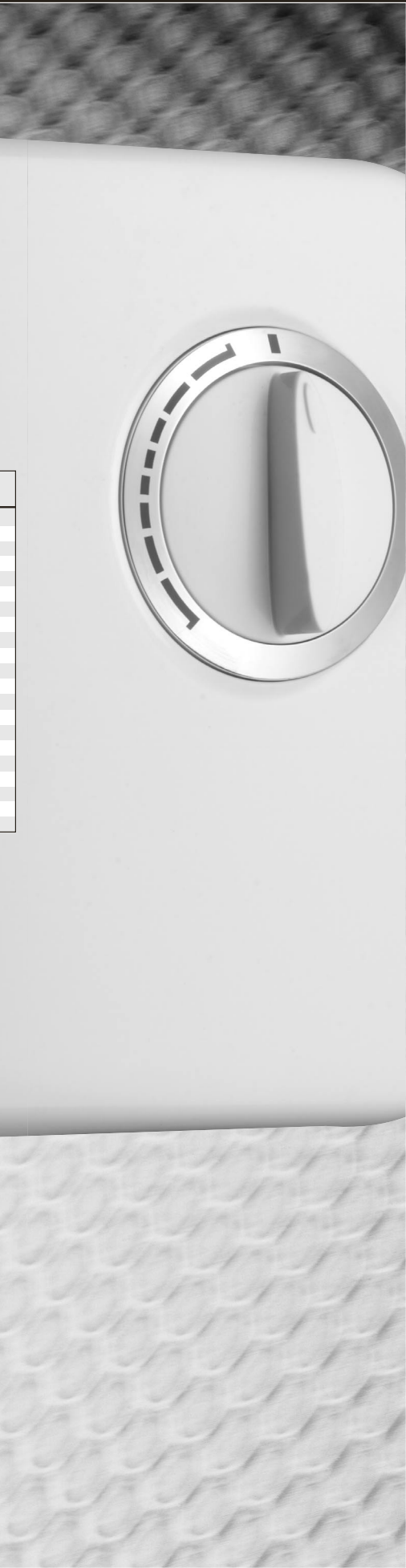

Contents

Installation and Operating Instructions for ShowerForce Power Shower

• 1000-XM

Please read this booklet carefully and ensure a competent person undertakes the installation.

Note: Following the headings in sequence will guide you through the installation and operation of your ShowerForce 1000-XM.

	Pages
PLANNING YOUR INSTALLATION	3
• Plumbing	
• Electrics	
FITTING YOUR SHOWER	4 - 7
• General	
• Plumbing Connections	
• The Unit	
• Water/Electrical Connections	
• Riser Rail	
COMMISSIONING	7
SETTING THE TEMPERATURE LIMIT STOP	8 - 9
USER INSTRUCTIONS	10
TROUBLE SHOOTING	10
SPARE PARTS LISTING	11 - 12
GUARANTEE	13

Refer to back cover for Guarantee, Customer Service and Replacement Parts Policy.
In the event of any query regarding installation please contact the NewTeam Customer Service Department

Tel: 01536 264 012 • Fax: 01536 409 201
E-mail: service@newteam.co.uk • E-mail: spares@newteam.co.uk

In line with our policy of continual product development the specifications may be varied and product design altered. We reserve the right to depart from the details given in this manual without prior notice.

Planning your Installation

Plumbing

- For correct operation of the ShowerForce 1000-XM Power Shower both hot and cold water supplies to the unit must be gravity fed, at equal pressures, from a cold water storage tank and hot water storage cylinder, Fig 1.
- We recommend a minimum 115 litre (25 gallon actual) cold water storage tank. Please ensure compliance with all Water Regulations. Under no circumstances must the Power Shower be connected to the mains cold water supply.
- Do not use jointing compounds.
- Before proceeding with the installation of this unit, check that your site requirements allow the top of the unit to be a minimum of 75mm below the bottom of the cold water storage tank.

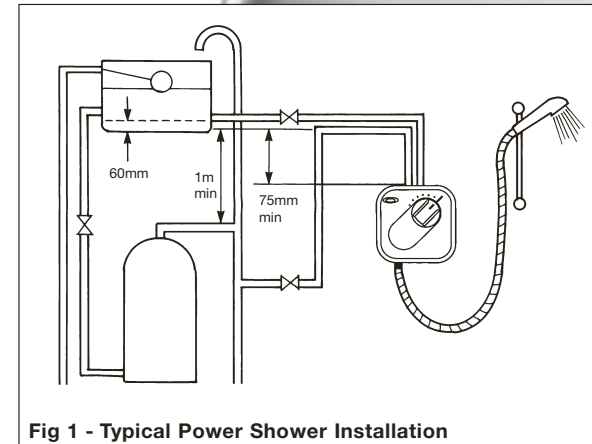

Fig 1 - Typical Power Shower Installation

Electrics

WARNING: THIS APPLIANCE MUST BE EARTHED.

All electrical wiring for the shower must comply with the current I.E.E Regulations which includes earth-cross bonding to all metal pipework.

IMPORTANT:

All plumbing connections should be completed before any electrical connections are undertaken.

The shower must be connected to a 230/240 volt. A.C electrical supply from a 13-amp ring main, via a fused double pole switch with at least 3mm contact separation. The switch is to be clearly identifiable, a minimum distance of 2.5m from a fixed tap or shower, e.g. mounted in an adjacent room. It should be fused at 3 amps.

As the colours of the wires in the cable (not supplied) used to connect to this appliance may not correspond with the coloured markings identifying the terminals in your switch, please follow the procedure below:

Procedure:

- The wire, which is coloured Blue or Black, must be connected to the terminal that is marked with the letter N.
- The wire, which is coloured Brown or Red, must be connected to the terminal that is marked with the letter L.
- The wire which is coloured Yellow/Green must be connected to the terminal which is marked with the earth symbol ⊕.
- The installation and wiring must comply with I.E.E regulations.

Fitting your Shower

General

In addition to the recommendation on 'Planning your Installation' please take note of the following:

- All plumbing should be completed before any electrical connections are undertaken.
- The unit can be connected to a combination cylinder system providing it has a cold water storage capacity of 115 litres (25 gallons actual).
- When connecting pipework avoid using elbows: sweep or formed bends will ensure optimum performance.
- Do not solder within 300mm of the unit.
- Do not run pump dry this will damage the internal seal and invalidate the warranty.
- All pipework to and from the unit should be a minimum of 15mm. Non-restrictive isolating valves must be fitted on hot and cold supply pipes.
- Do not position unit in areas subjected to freezing conditions.

WARNING – ALL CONNECTING PIPEWORK SHOULD BE EARTHED

Procedure - Plumbing Connections: Fig 1.

1. Isolate mains water and electrical supplies.
2. To empty the pipework open the hot and cold water taps.
3. Make your connection into the hot water supply pipe from the cylinder, ensuring that it is the first draw-off (below the expansion pipe tee) to minimise the effects of water draw offs elsewhere in the house, and a minimum of 1 metre from the base of the cold storage tank and the expansion tee.
4. If this is not possible, a direct connection must be made from the hot water cylinder with a cylinder flange, Fig 2.
5. The cold water supply should be taken directly from the cold storage tank, and must be positioned 60mm below the cold feed connection to the hot water cylinder. This should not be directly beneath the ball valve as aeration of the water going to the shower could cause pump damage.
6. Run hot and cold pipework to the unit position.

The Unit

We recommend that the unit is fitted at chest height, and set to one side of the intended riser rail position, ensuring that the top of the unit is at least 75mm below the base of the cold water tank.

IMPORTANT:

- The unit must be fitted on the finished tiled surface.
- Do not seal the edge of the unit to the tiled surface with any sealant, as the gap below the back of the unit and the tiles is needed for ventilation.
- The outlet connection must be positioned at the bottom of the unit

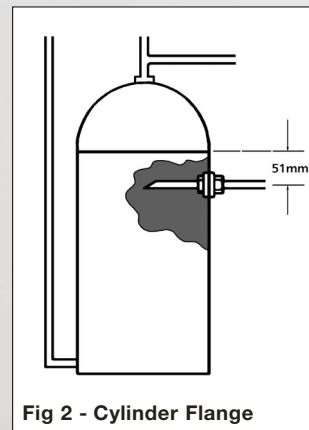

Fig 2 - Cylinder Flange

Water/Electrical Connections

WARNING:
Do not fit fuse or switch on mains electrical supply until all plumbing work is completed. Connecting pipework can feed from above or below the unit, or straight through the wall at nominal centres of 40mm.

- Top Feed** = Hot on the right /cold on the left
Bottom Feed = Hot on the left/cold on the right
Back Feed = Hot on the bottom/cold on the top

- Procedure:**
- The integral fittings on the valve are of the self-seal push-fit type. All burrs and rough edges must be removed from the end of the tube. Where chrome plated tube is used, roughen or remove the first 25mm of plating
 - The inlet elbows supplied are of a standard length, in some cases these will need to be shortened for correct installation, please refer to the tables for correct measurements.

- 1000XM - Fig 5.**
1. Flush out pipework before installing the unit.
 2. Cut the inlet elbows to the required length, please refer to table below.
 3. Locate the inlet elbows into the mixer valve inlets by pushing firmly through rubber grommets until pipe stop is felt.
 4. Hold the unit on the wall and mark the pipe work to the appropriate length.
 5. Cut the pipes and remove all burrs. Push the unit and elbows firmly onto the pipes until the stop is felt.
 6. Mark the fixing points for the unit, Fig 3.
 7. Release unit from pipes by pressing the grey collets on the elbow fittings, and pulling the unit off the pipework, Fig 4.
 8. Drill the wall and insert the appropriate wall fixings.
 9. Bring a supply cable (to conform to I.E.E regulations) from the switch to the unit position. The cable can enter the unit from the rear, or via channels in the base of the unit, and the bottom or the right hand side.
 10. Feed the supply cable in to the unit but do not connect.
 11. Refit unit to pipes and secure to wall using 32mm x No.8 screws provided.
 12. Connect the supply cables into the appropriate terminals (marked N, L and ⊕ symbol) on the printed circuit board, and secure in position with the cable clamp.
 13. Fix the cover (1) and secure with the fixing screws provided (2), Fig 5.
 14. Push the control knob (3) onto the spindle ensuring that the splines on the knob align with the same splines on the control knob (3).
 15. Attach the shower hose (handtight) to the outlet connection, using the rubber washer provided.
 16. Commission the shower, see page 6.
 17. Set the Temperature Limit Stop, see page 8.

NOTE: If the electrical supply cable is concealed in the wall ensure that it avoids the unit's fixing points so that fixing screws do not pierce the cable.

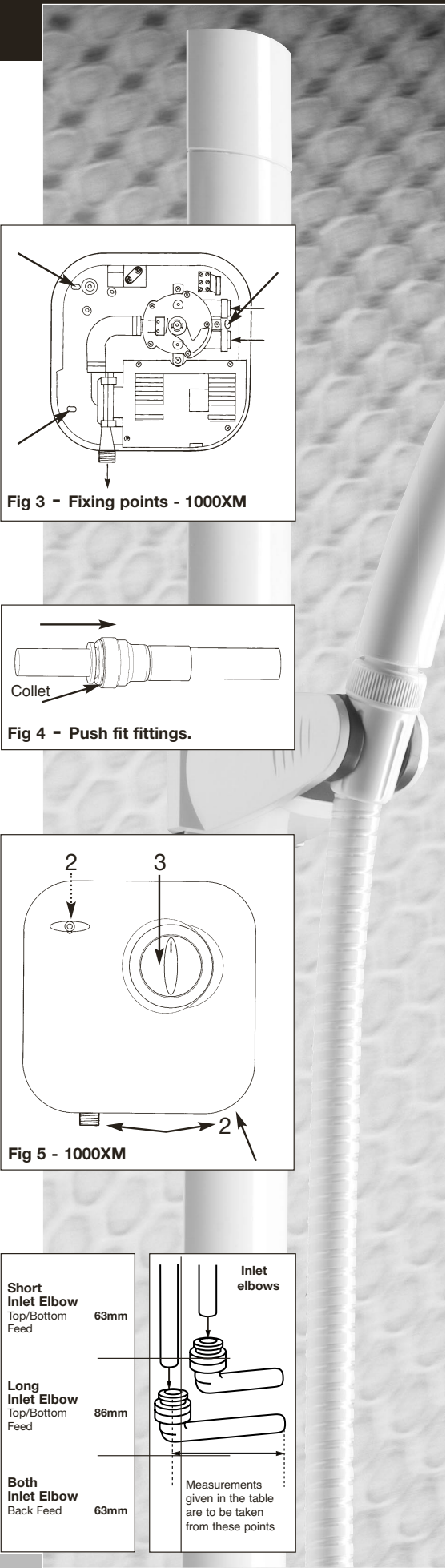

Fitting the Riser Rail

Spirit Rail Kit

Before proceeding with fitting the rail, identify each of the items supplied using the illustration.

The slider need not be removed from the rail during fitting. The top of the slider has a smooth profile, whereas the underside has a recess revealing the grooves on the handset holder.

No	Part Description
1	Rail end cap
2	Spirit level
3-4	Rail with slider attached
5	Hose retainer/Gel Hook
6	Screw cap
7	Hose retainer fixing screw
	Rail fixing screws & wall plugs

Fit the hose retainer onto the bottom end of the rail and secure using the small screw from the kit.

Position the rail on the wall, bearing in mind the heights of people likely to use the shower, and the length of the hose when connected to the shower and passed through the hole in the hose retainer. Mark the wall to indicate the upper fixing screw position. Screw centres are 605 mm (approx. 23 inches,) apart.

Drill the wall at the marked fixing position using a 6 mm drill, and loosely fix the rail end, checking that the rail is hanging vertically using the spirit level incorporated into the top end of the rail. The bubble should be exactly between the two lines on the spirit level body. Mark the position for the lower fixing screw, move the rail to one side, drill the wall, and fix the lower end of the rail.

Check that the rail is vertical and tighten both fixing screws.

Slide the end cap into position on the top end of the rail, and fit the screw cover into the recess in the hose retainer.

When fitting the hose, it should pass through the hole in the hose retainer.

NOTE: The hose nut, and not the handset handle, fits into the slider, and the slider moves more freely on the rail if gripped next to the rail, rather than at the handset.

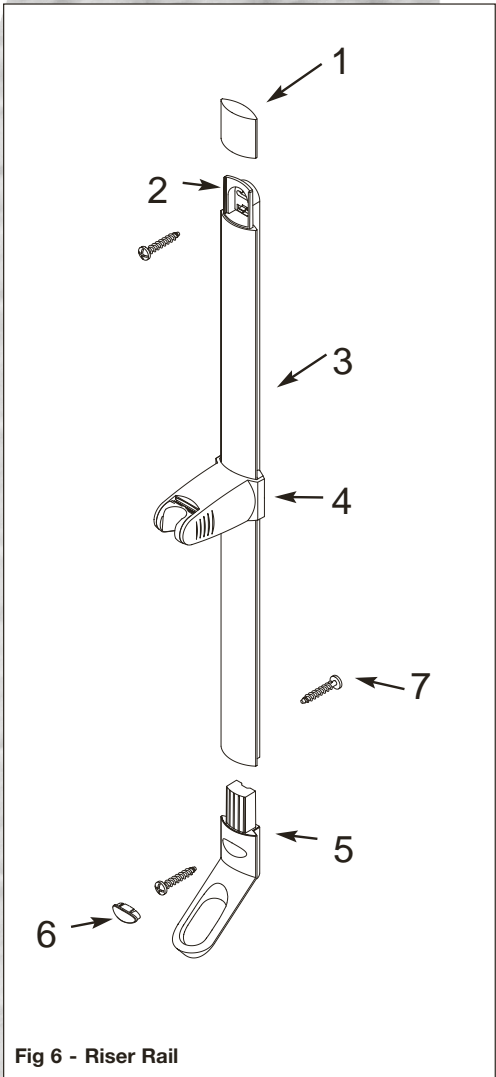

Commissioning

1. Turn on the water supplies and allow the system to fill. Do not attach handset to hose.
2. Turn on the shower using the Control Knob, and run shower for 2-3 minutes through the hose to ensure that no foreign matter is left in the pipes. Turn off mixer valve.
3. Switch on electricity supply.
4. Switch on shower using the Control Knob and allow to run for a further 2-3 minutes.
5. Attach handset to hose using the rubber washer provided.
6. Set Temperature Limit Stop, refer to pages 7-8.
7. Demonstrate to shower user.

Temperature - Limit Stop Fig 7 & 8

The valve allows the maximum showering temperature to be set at a safe level, preventing accidental scalding. This setting should be made during commissioning and will require that the hot water cylinder is at its normal operating temperature.

IMPORTANT:

- The handset must be in the spray mode.
- We recommend the reading of User Guide before proceeding further. This will familiarise you with the operation of the shower.

Procedure:

1. Remove the control knob (1) by pulling firmly.
2. The temperature limit stop adjuster (2) has three positions A, B & C, giving a range of temperature adjustment settings from cool to hot A being the coolest. Fig 8.
3. If adjustment is necessary, remove the locking screw (3) and relocate adjuster (2) in fixing position A, B or C, depending on the user's requirement for maximum temperature. Fig 8.

NOTE: This position may be affected by the stored water temperature in the cylinder.

4. Retighten locking screw (3). Re-fit control knob ensuring that the splines on the knob align with the same splines on the control knob (1) and switch on shower, rotating knob fully anti clockwise to the maximum temperature setting.
5. Check if this meets the user's required maximum temperature. If not, fine adjustment can be made by slackening the locking screw (3) and moving the adjuster (2) anti-clockwise to increase or clockwise to decrease the temperature.
6. If the desired temperature cannot be obtained on the first selected fixing position, move the adjuster to the next hole and repeat the steps above.

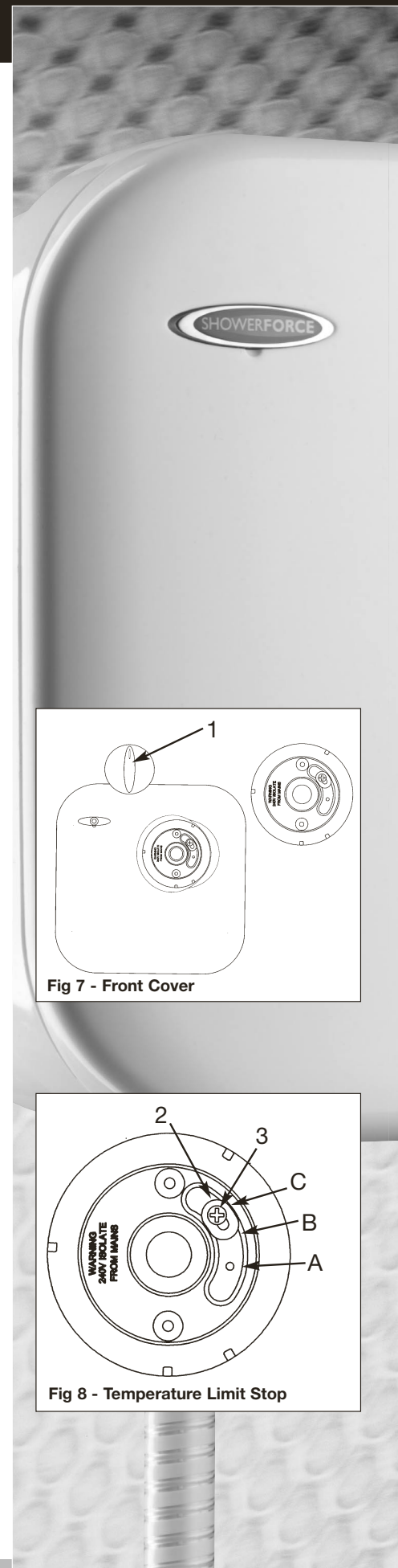

Setting the Temperature Limit Stop

ShowerForce 1000-XM

- To switch the shower on, turn the control knob (1) anti-clockwise. Water will flow from the handset. Fig 9.
- Rotating the control knob (1) anti-clockwise from the off position will gradually increase the showering temperature.

Handset

The handset supplied has three spray modes:

Spray • Massage • Combination

To select your desired showering mode, grip the bezel of the handset and twist in either direction.

WARNING:

Before carrying out any general repairs or tests to the shower, please ensure that the electricity supply is turned off at the mains and the correct circuit fuse is removed.

Troubleshooting

Symptom	Likely Cause	Action / Remedy
Pump not operating	Electric is not switched on	Check all fuses and electricity supply
Pump operates when mixer is switched off	Micro switch is not operating correctly	Check micro switch lever is securely located
No water flow (Hot or Cold)	Isolating valves turned off	Turn on isolating valves Check cold water storage tank has not run dry
Poor performance	Poor hot or cold flow Pump motor may have overheated	Check hot and cold supplies Allow unit to cool and it will automatically re-set Check for adequate ventilation
	Unit may be in the wrong position	Check that the top of the unit is at least 75mm below the base of the cold water storage tank

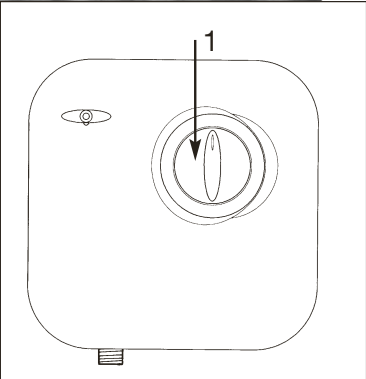

Fig 9 - 1000XM