

Please tape down

Please tape down

3rd Fold

Affix  
Stamp



**NewTeam Ltd.**

Customer Service Dept.  
Brunel Road  
Earlstrees Industrial Estate  
Corby  
Northants  
NN17 4JW

1st Fold

2nd Fold

# Installation Instructions and User Guide

**SHOWERFORCE RIVA  
MIXER SHOWER**

**IN THE EVENT OF ANY QUERY PLEASE CONTACT  
THE NEWTEAM CUSTOMER HELPLINE**

**Tel : 01536 264 012**



**PLEASE KEEP THIS BOOKLET  
FOR FUTURE REFERENCE**

**DEAR INSTALLER WHEN YOU HAVE READ THESE INSTRUCTIONS  
PLEASE ENSURE YOU LEAVE THEM WITH THE USER**

## ShowerForce Riva

- High flowing valve, designed to work on low water pressures, whilst also capable of operation on up to 5.0 bar mains pressure.
- High quality brass bodied valve using ceramic disc technology.
- Adjustable temperature limit stop.
- Servicing from front of valve, even when recessed.
- Brass swivel elbows to suit top, bottom or rear entry pipework.
- Single lever temperature and flow controls.

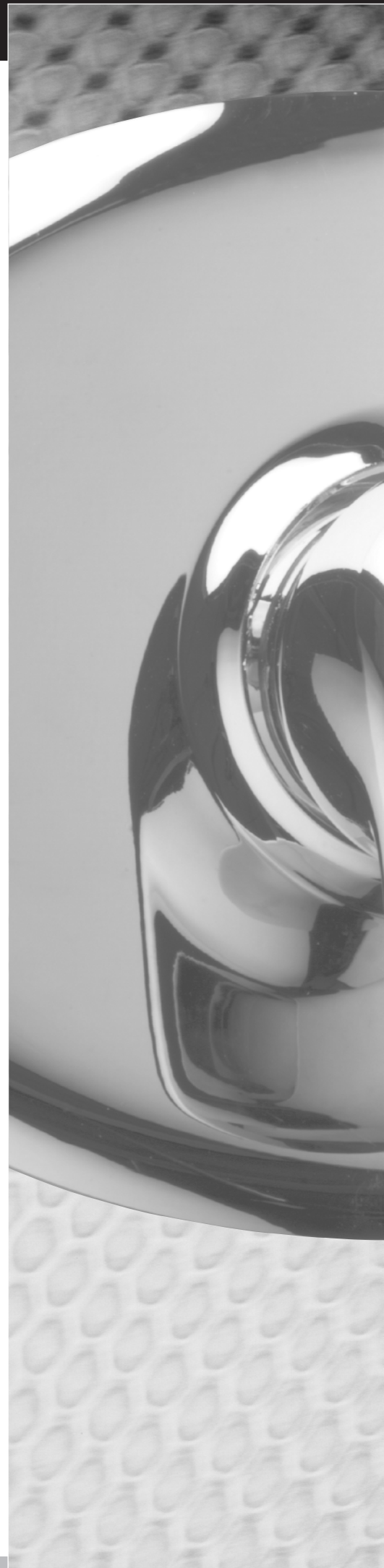

# Contents

## Installation and Operating Instructions for ShowerForce Mixer Shower

### • Riva

Please read this booklet carefully and ensure a competent person undertakes the installation.

Note: Following the headings in sequence will guide you through the installation and operation of your ShowerForce Riva Mixer Shower.

	Pages
<b>PLANNING FOR YOUR INSTALLATION</b>	<b>3</b>
<b>FITTING YOUR SHOWER</b>	<b>4</b>
• Plumbing	
• Surface Mounted Fixing	
• Recessed Mounting Fixing	
<b>USER INSTRUCTIONS</b>	<b>5 - 6</b>
<b>SHOWER SET FIXING</b>	<b>7</b>
<b>TROUBLE SHOOTING</b>	<b>8</b>
<b>SPARE PARTS LISTING</b>	<b>8</b>
<b>GUARANTEE</b>	<b>10</b>

Refer to back cover for Guarantee, Customer Service and Replacement Parts Policy. In the event of any query regarding installation please contact the NewTeam Customer Service Department

**Tel: 01536 264 012 • Fax: 01536 409 201**

**E-mail: [service@newteam.co.uk](mailto:service@newteam.co.uk) • E-mail: [spares@newteam.co.uk](mailto:spares@newteam.co.uk)**

In line with our policy of continual product development the specifications may be varied and product design altered. We reserve the right to depart from the details given in this manual without prior notice.

## General

The ShowerForce Riva Mixer Valve is suitable for the following:

- High Pressure systems to a maximum of 5.0 Bar (50 Metre Head).
- Low Pressure systems with a minimum pressure of 0.1 Bar (1 Metre Head).
- Pumped Pressure.
- Mains Pressure.
- Unequal Pressure with a maximum differential of 10:1.

Ideally the supplies should be independent of any other draw offs (e.g. bath/basin taps).

If the minimum operating pressure cannot be achieved or you wish to improve the performance of your shower, ShowerForce Booster Pumps are available.

The Valve can be both Surface and Recess mounted. To recess the Valve, the Trim & Recessing Kit is included in your box contents.

### IMPORTANT:

When connecting pipework do not solder within 300mm (12") of the valve or expose parts to excessive heat.

Before installing the Valve in a recessed position ensure that there is a distance of 65mm from the back of the Valve housing and the intended finished tile surface.

The temperature of your stored water must not exceed 65°C. A stored water temperature of 60°C is considered sufficient to meet all normal requirements in line with the British Standard 6700

## Plumbing - Fig 1

Please ensure compliance with all Water Supply (Water Fitting) Regulations paying particular attention to Clause 15, when connecting directly to incoming cold water mains.

The Mixer Valve must be sited to provide easy access for use and maintenance.

Install non-restrictive full flow isolating valves on the hot and cold supplies to the Mixer Valve.

Ensure the Mixer Valve is not positioned in an area subject to freezing.

Make the connection into the hot water supply pipe from the cylinder ensuring that it is the first draw off on the vertical pipe below the expansion pipe tee. If this is not possible a direct connection must be made from the hot water cylinder with an Essex flange.

The cold water supply should be taken directly from the cold water storage tank positioned 60mm below the cold connection which feeds the hot water cylinder.

Run the pipework to the valve at 110-116mm centres, using 15mm pipe and make the connections to the inlets as detailed in the 'Fitting your Shower' section (Pages 4 & 5). These can enter the valve from either the top, bottom or rear.

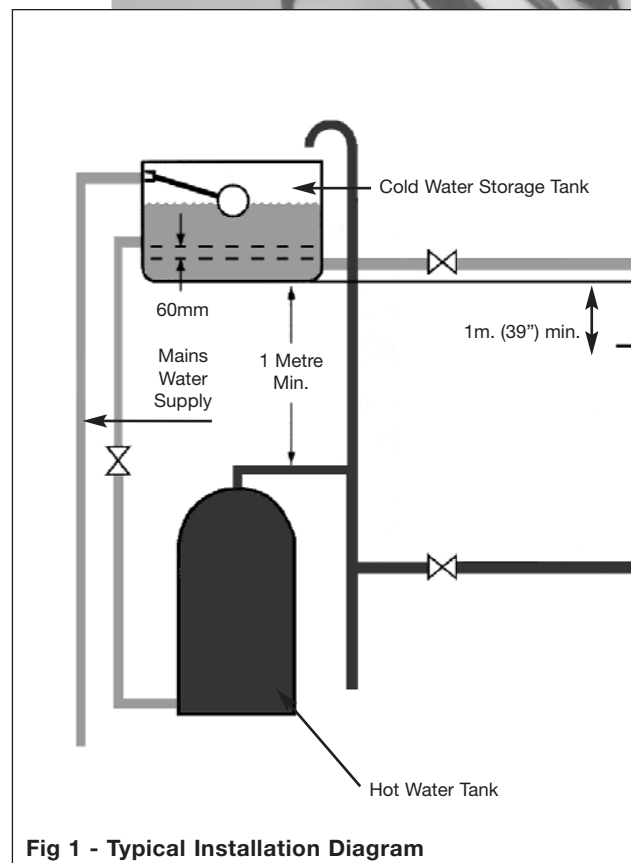

Fig 1 - Typical Installation Diagram



## Fitting Your Shower - Fig 2

### FITTING THE RIVA MIXER VALVE- SURFACE MOUNTED OPTION

1. Select the Mixer Valve position to suit the end user.
2. Using the back plate as a template, mark the two fixing points, drill and fix using the screws and wall plugs provided. If the valve is to be fixed to plaster board or a similar material then a suitable fixing method should be used.
3. Bring the pipework to the Valve position at 110-116mm centres. HOT ON THE LEFT, COLD ON THE RIGHT.
4. Flush out pipework before fixing the Valve.
5. Place the Valve onto the fixing plate and tighten the two grub screws.
6. Ensure that the 15mm pipe which is to enter the elbow connection is free of any sharp edges or burrs.
7. From the fully tightened position unscrew the inlet elbows to the appropriate position to accept the incoming pipework. i.e. from the top, bottom or rear.
8. Ensure the Valve is turned off and then turn on the water supplies and check that the installation is water tight.

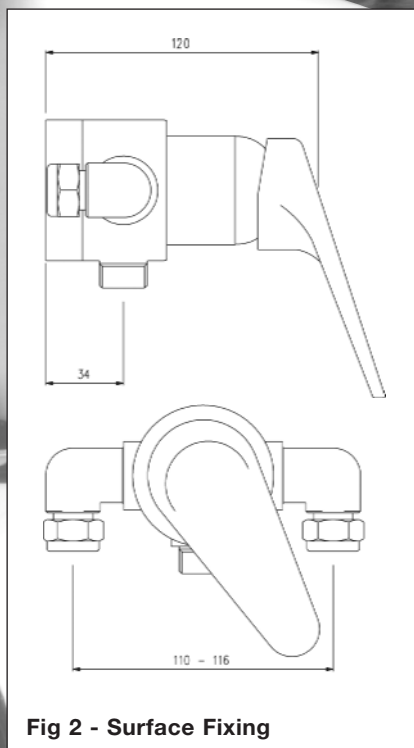

Fig 2 - Surface Fixing

## Fitting Your Shower - Fig 3

### FITTING THE RIVA MIXER VALVE - RECESSED OPTION

Before installing the Valve in a recessed position ensure that there is a distance of between 55mm and 85mm from the back of the shower valve and the intended finished tile surface.

1. Select the location for the shower valve and cut a oval hole smaller than the concealing plate.
2. Remove the backplate off the shower valve by removing the grub screw, you can now use this a template to set out the location for the four retaining screws.
3. The inlet elbows can be unscrewed to allow for pipe work centres of 110mm to 116mm.
4. Place the shower valve onto the pipe work ensuring that the HOT side is on the left secure the compression fittings and secure the shower valve onto the backplate.
5. Connect the outlet pipe, again make sure the compression fitting is secure.
6. Make sure the valve is turned off and turn the water supply back on to make sure the connections are watertight .
7. Place the seal onto the concealing plate and push the plate over the shower valve.

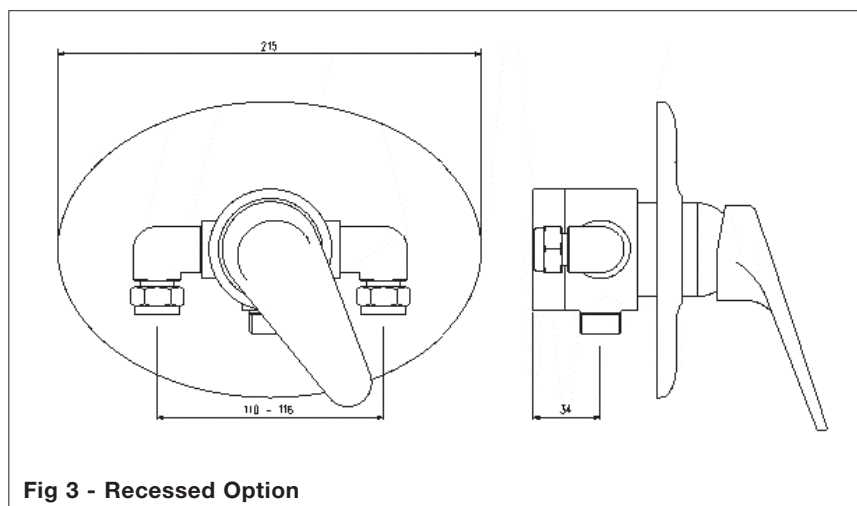
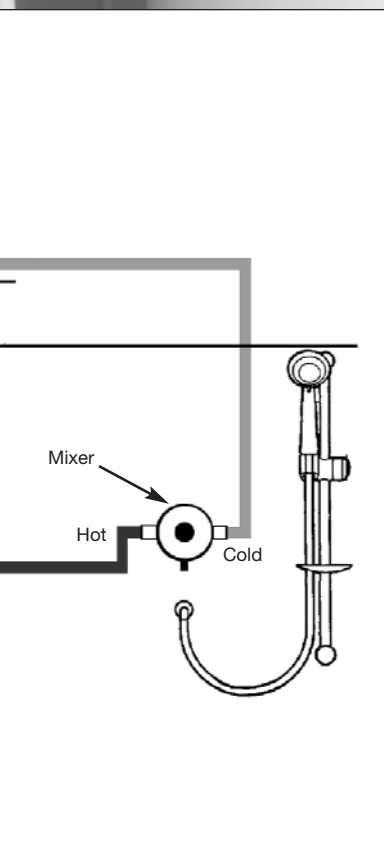

Fig 3 - Recessed Option

## RIVA MIXER SHOWER - Fig 4

The ShowerForce Riva Mixer Valve has single lever control for both the temperature and flow.

The ShowerForce Riva Mixer Valve features a temperature limit stop to prevent accidental selection of high temperatures.

For maximum water temperature and flow rate adjustment, the chrome control head should first be removed by unscrewing the M5\*16L grubscrew, this screw is protected by a plastic cap.

Once the screw is removed the lever will then slide off the cartridge mounting. Unscrew the top thread exposing the cartridge for adjustment.

Maximum water temperature can be controlled by the adjustment of ring 'A' (colour red), against stop 'B'. The red ring can be pulled away from the cartridge body to allow it to be re-positioned (note arrow direction and +/- signs. The rotation is limited by the angular stops on ring 'A' and stop 'B'.

Flowrate is adjusted by screw 'C' using a 1.5 A/F hexagon allen key. Adjust clockwise to decrease flowrate.

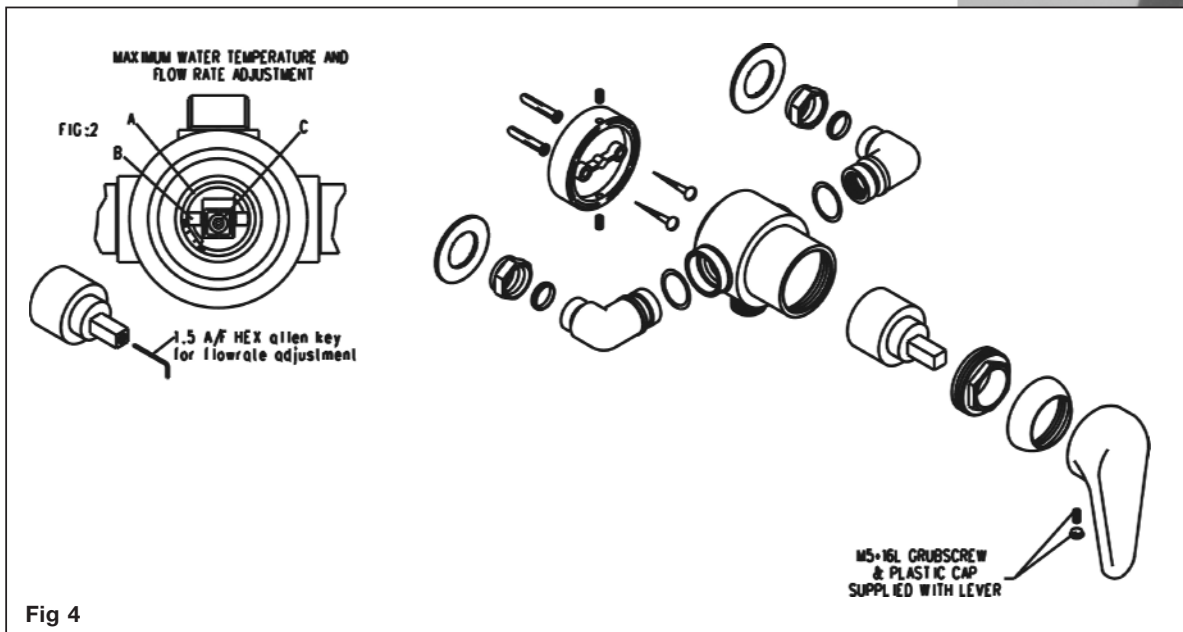

Fig 4

## Installation (Contd.)

### MAINS COLD SUPPLY

- A) \*Hot supply between 1 to 4 metres (0.1-0.4 bar)  
Mains cold supply up to 10 bar.  
\*Fit 7 litre (green) limiter into cold inlet elbow only.
- B) \*Hot supply above 5 metre (0.5 bar)  
Mains cold supply up to 10 bar.  
\*Fit 5 litre (yellow) limiter into hot inlet elbow.  
\*Fit 7 litre (green) limiter into cold inlet elbow.

### UNVENTED SYSTEM

- Fit 5 litre (yellow) limiter into hot inlet elbow.  
Fit 7 litre (green) limiter into cold inlet elbow.

This will give a shower outlet of about 10litres/min. (2.2 gallons per min).  
(Cold supply to shower from same source as hot).

### INSTANTANEOUS GAS WATER HEATER & COMBINATION BOILER (UNVENTED)

The hot supply from the heater is to be connected to the hot inlet elbow and cold inlet elbow connected to the cold supply. Fit 7 litre flow limiter (as supplied) into the cold inlet elbow.

### INSTANTANEOUS (NON STORAGE)

7-9kw Electric Water Heaters (Unvented)

This will require a 5 litre (yellow) flow limiter as supplied into Cold outlet only.

**IMPORTANT:** It is a requirement of Instantaneous Electric Water Heaters that a stable flow of water passes through the heater.

This requirement can be satisfied by using a Flow Stabilizer and should be adjusted to give a temperature of between 50 & 55°C from the heater.

Flow Stabilizers should be fitted prior to the heater.

### PUMPED SHOWERS

Your Thermostatic shower is also ideal for power shower installation and can be matched to the ShowerForce range of shower pumps.

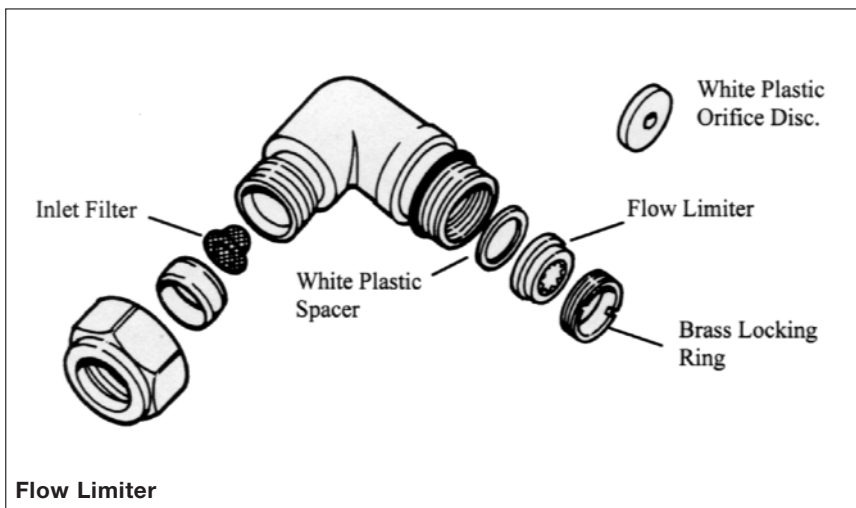

## Spirit Rail Kit

Before proceeding with fitting the rail, identify each of the items supplied using the illustration.

The slider must not be removed from the rail during fitting. The top of the slider has a smooth profile, whereas the underside has a recess revealing the grooves on the handset holder.

No	Part Description
1	Rail end cap
2	Spirit level
3-4	Rail with slider attached
5	Hose retainer
6	Screw cap
7	Hose retainer fixing screw
	Rail fixing screws & wall plugs

Fit the hose retainer onto the bottom end of the rail and secure using the small screw from the kit.

Position the rail on the wall, bearing in mind the heights of people likely to use the shower, and the length of the hose when connected to the shower and passed through the hole in the hose retainer. Mark the wall to indicate the upper fixing screw position. Screw centres are 605 mm (approx. 23 inches,) apart.

Drill the wall at the marked fixing position using a 6 mm drill, and loosely fix the rail end, checking that the rail is hanging vertically using the spirit level incorporated into the top end of the rail. The bubble should be exactly between the two lines on the spirit level body. Mark the position for the lower fixing screw, move the rail to one side, drill the wall, and fix the lower end of the rail.

Check that the rail is vertical and tighten both fixing screws.

Slide the end cap into position on the top end of the rail, and fit the screw cover into the recess in the hose retainer.

When fitting the hose, it should pass through the hole in the hose retainer. Hose connections only require hand tightening.

**NOTE:** The hose nut, and not the handset handle, fits into the slider, and the slider moves more freely on the rail if gripped next to the rail, rather than at the handset.

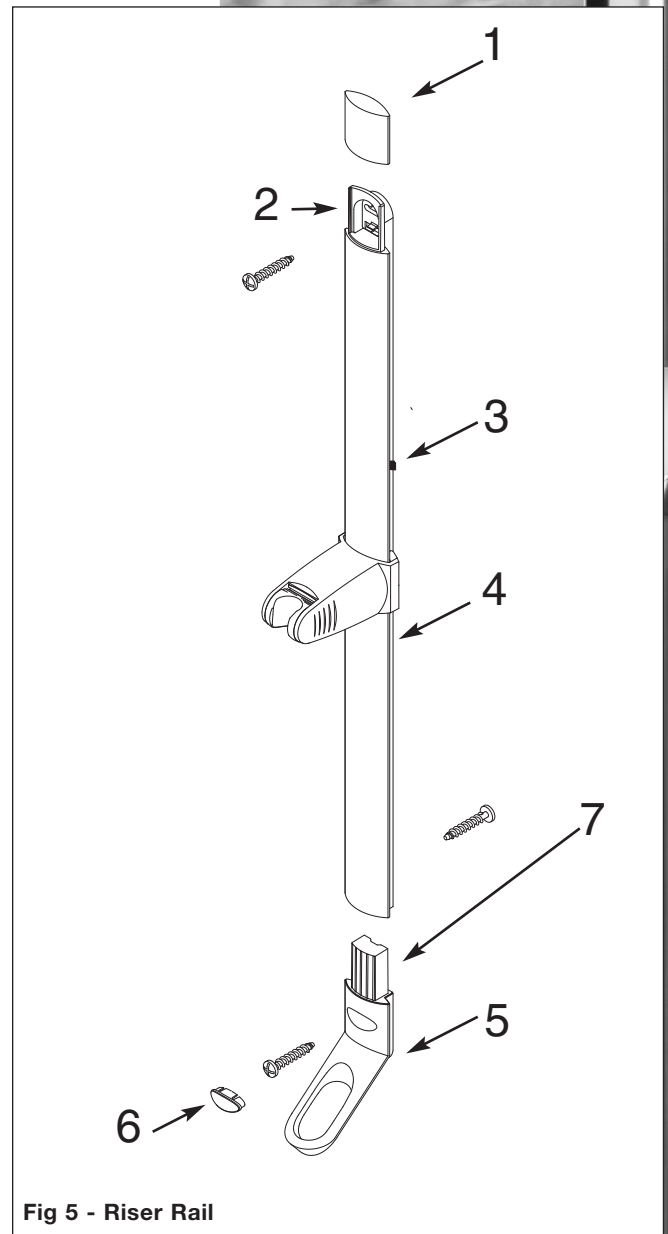
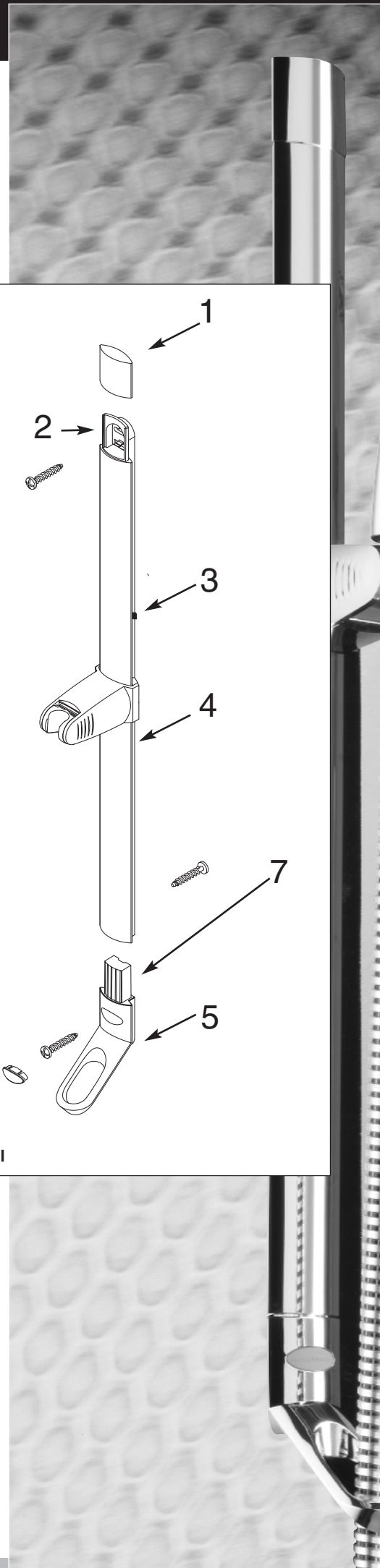

Fig 5 - Riser Rail



# Trouble Shooting

Symptom	Likely Cause	Action/Remedy
No water flow (Hot or Cold)	Isolating valves turned off	Turn on isolating valves
Poor performance	Poor hot or cold flow  Blocked Handset	Check hot and cold supplies  Clean or replace Handset

## Spare Parts

Part No.	Description
SK 1501 - 2	Cartridge Kit
280-0100**	Spirit Rail/Slider Assy
280-0024**	Rail End Cap
280-0032**	Rail End Hose Retainer
168-0211**	Zag Single Mode Rubclean H/set
280-0025	Rail Logo Button
285-0820**	Hose 1.5mt LB
280-0035	Spirit Level 16x7 DIA

\*\*Please indicate colours

## Guarantee

Thank you for purchasing a ShowerForce product, which has been designed, manufactured and tested, in the U.K., to the highest standards, by NewTeam Ltd.

**Guarantee.** 2 Years - First Year - Parts and Labour, Second Year - Parts Only

This is provided that:

1. The guarantee registration card is completed and returned within ten days complete with a copy of proof of purchase.
2. The product is installed and operated in accordance with our instructions and has not been misused or damaged.

This in no way affects your statutory rights as a consumer.

The information on the Guarantee card helps ShowerForce to process any claims and contact you about your product and its maintenance if required. The registration of your personal details is purely for Showerforce use, and the other information helps us to make products for the future.

ShowerForce Shower products are designed, manufactured and tested to the highest standards.

Should a complaint arise, products are guaranteed against faulty workmanship and materials for a period of 12 months from the date of purchase, when in domestic use (second year guarantee is parts only). For your guarantee to be valid, your shower pump must be installed by a competent person, in accordance with the instruction manual.

ShowerForce will repair or replace (at our option), free of charge, any faulty components during the guarantee period, provided it has been maintained and operated in accordance with our instructions, and has not been misused or damaged.

Modification or repair of this product by person(s) not authorised by ShowerForce will invalidate this guarantee.

**This guarantee applies to products purchased within the United Kingdom or Republic of Ireland, but does not apply to products used commercially.**

This guarantee does not affect your statutory rights.

## Service Policy - Replacement Parts Policy

### IMPORTANT:

In the event of product or component malfunction, DO NOT tamper with or remove the product from site. Telephone ShowerForce Customer Service Department on 01536 264 012 and be prepared with the date of purchase, model number and a description of the complaint.

Our service staff are fully qualified to advise on correct installation procedures and will be able to diagnose whether the fault will require a replacement part or a visit from a ShowerForce engineer.

If required, a service call will be booked, and either yourself or an appointed representative (who should be a person of 18 years or over) must be present during the visit.

All site visits to product within the guarantee period will be carried out free of any parts or labour charges provided the conditions of the guarantee have been adhered to. (Second year guarantee is parts only)

All site visits to product out of guarantee will be subject to charges for parts and labour which is payable by you or your appointed representative at the time of the visit. Charges will also be levied on cancelled appointments, unless advised to ShowerForce at least 24 hours in advance of the agreed date and time.

We reserve the right not to undertake work where payment cannot be made to our engineer at the time of the visit.

ShowerForce hold stocks of components for all their range of products and these will be maintained for the duration of their life.

Should a product be discontinued, spare parts stocks will be maintained, but in the event of a part becoming unavailable ShowerForce reserve the right to supply a substitute of equal quality.

The following payment methods can be used to obtain spare parts:

By post, pre-payment of proforma invoice by cheque or postal order.

By telephone quoting credit card (Mastercard, Visa or Visa Delta) details.

### REPLACEMENT PARTS:

**Tel: 01536 409 222 • Fax: 01536 409 201 • E-Mail:spares@newteam.co.uk**

### CUSTOMER SERVICE HOTLINE:

**Tel: 01536 264 012 • Fax: 01536 409 201 • E-Mail:service@newteam.co.uk**

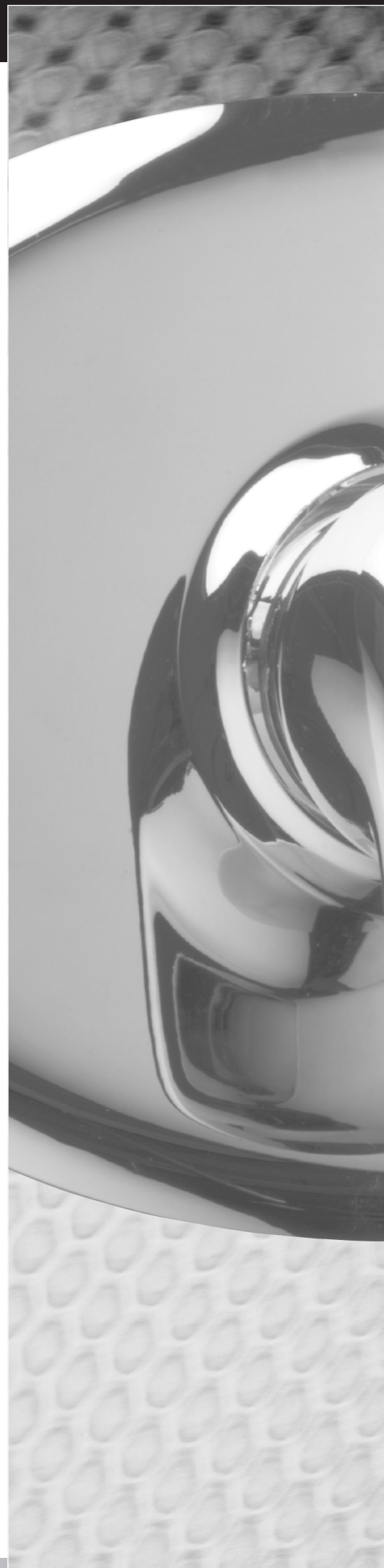

# GUARANTEE CARD

Please post immediately enclosing a copy of proof of purchase

FOR SHOWERFORCE USE

AFFIX PRODUCT LABEL HERE

This label identifies your product and provides all the information needed

ShowerForce Riva Mixer Shower

Proof of purchase enclosed

YES

NO

NAME:

ADDRESS:

POSTCODE:

DATE OF PURCHASE:

PRODUCT PURCHASED FROM:

TOWN:

ShowerForce/NewTeam's philosophy is to offer outstanding products with quality and integrity, please help us by taking the time to answer the following questions. Thank you.

### MARKETING INFORMATION

1. Please state your profession: Plumber  Builder  Electrician  Customer   
Other  (please specify) \_\_\_\_\_

2. Please state the reason for purchasing a shower: New Build  Replacement   
Renovation  Other  (please specify) \_\_\_\_\_

3. If the product is a replacement shower, please state the type and make of the shower it is replacing: \_\_\_\_\_

4. What influenced you to purchase the Riva Mixer Shower? Advertisement   
Trade Press  Recommendation from Stockist  Recommendation from Installer   
Other  (please specify) \_\_\_\_\_

5. Please state your main reason for purchasing the Riva Mixer Shower:  
ShowerForce Product Knowledge  Product Features  Product Styling  Price   
Other  (please specify) \_\_\_\_\_

Please tick here if you do not require any further information or product updates from NewTeam

**POST BACK**

**FOLD AND TAPE AS INSTRUCTED OVERLEAF**